

OIL PUMP - ALUMINUM 1948-1953



No.	Part No.	Description	Year
-	669016	Pump: Complete, original gear style	48-51
-	669016-L	Pump: Complete, original gear style	52-53
1	512004	Housing: Oil pump	48-53
Note: KIWI oil pump housings have more material around critical areas that normally crack.			
2	41372-L	Bushing: Drive shaft, recessed	48-53
Note: Indian calls this bushing out as p/n 41372, the same as in the 38-47 pump however it is NOT the same. We put an L designation to it to differentiate. We make it correctly.			
3	101030	Gear: Helical, drive shaft	48-53
4	101031	Rivet: Helical gear to drive shaft	48-53
5	776008	Shaft: Distributor drive	48-53
6	661006	Plug: 1/8" pipe	48-53
7	41373	Sleeve: Distributor	48-53
8	185007	Check ball	48-53
9	809024	Spring: Check ball, improved	48-53
10	KI-10005	Washer sealing kit: Return and sump elbows	48-53
11	464011	Gear set: set of 5	48-53
12	538001	Key: Shaft to gears (2)	48-53
13	776006	Shaft: Pump drive	48-53
14	464011-S	Stud: Idler gears	48-53
15	256004	Housing: Gear box	48-53



No.	Part No.	Description	Year
16	351003	Cover: Gear box	48-53
17A	185005	Ball: 1/8 Reed	48-53
17B	912003	Reed valve	48-53
17C	655013	Plate: Reed valve	48-53
17D	758004-K	Screw Kit: Reed valve	48-53
18	256004-C	Gear box: Complete, Tested and ready to fit in to your housing.	
19	751317-K	Screw kit: Gear box & cover	48-53
20	453005	Gasket: Pump to cam cover	48-53
21	453005-R	Cometic Gasket: Pump to cover	48-53
Note: Gasket is a Foamet material and will take up imperfections in surfaces to eliminate oil leaks			
22	45009	Set screw: Sleeve	48-53
23	45010	Set screw: Shaft bushing	48-53
24		Screw kit: Pump mounting to cam cover	
25	KI-10008		48-53
26			
Note: Use KI-10017 sealing washers in place of lock washers to reduce oil leaks			
27	KI-10017	Washer sealing kit: for KI-10008 screw kit	48-53
28	418002	Elbow: Feed, 3/8"	48-53
29	607013	Lock nut: Feed elbow	48-53
30	418006	Cone: 3/8 feed line, 3/8"	48-53
31	418007	Nut: 3/8 feed line, 3/8"	48-53
32	418031	Nipple: Return tube, 5/16"	48-51
33	418040	Elbow: Return tube, 5/16"	52-53
34	24B16	Elbow: 5/16, stainless	48-53
35	24B17	Lock nut: Elbow lock	48-53
36	418009	Cone: 5/16, return & sump lines	48-53
37	418008	Nut: 5/16 return & sump lines	48-53
38	568016	Feed & return lines: w/fittings Incl 30, 31, 36, 37, 38, pr.	48-51
38	568031	Feed & return lines: w/fittings Incl 30, 31, 36, 37, 38, pr.	52-53
39	568018	Tube: Crankcase & scraper to pump, incl 36, 37 w/fittings	48-53

Note: KIWI oil lines have the correct factory style fittings on the ends to ensure an oil tight seal. We have also improved the cone one step further by designing in a taper on the back side so as to mate correctly with the nut. Its small things like this that make the KIWI difference.

OIL PUMP - ALUMINUM 1948-1953

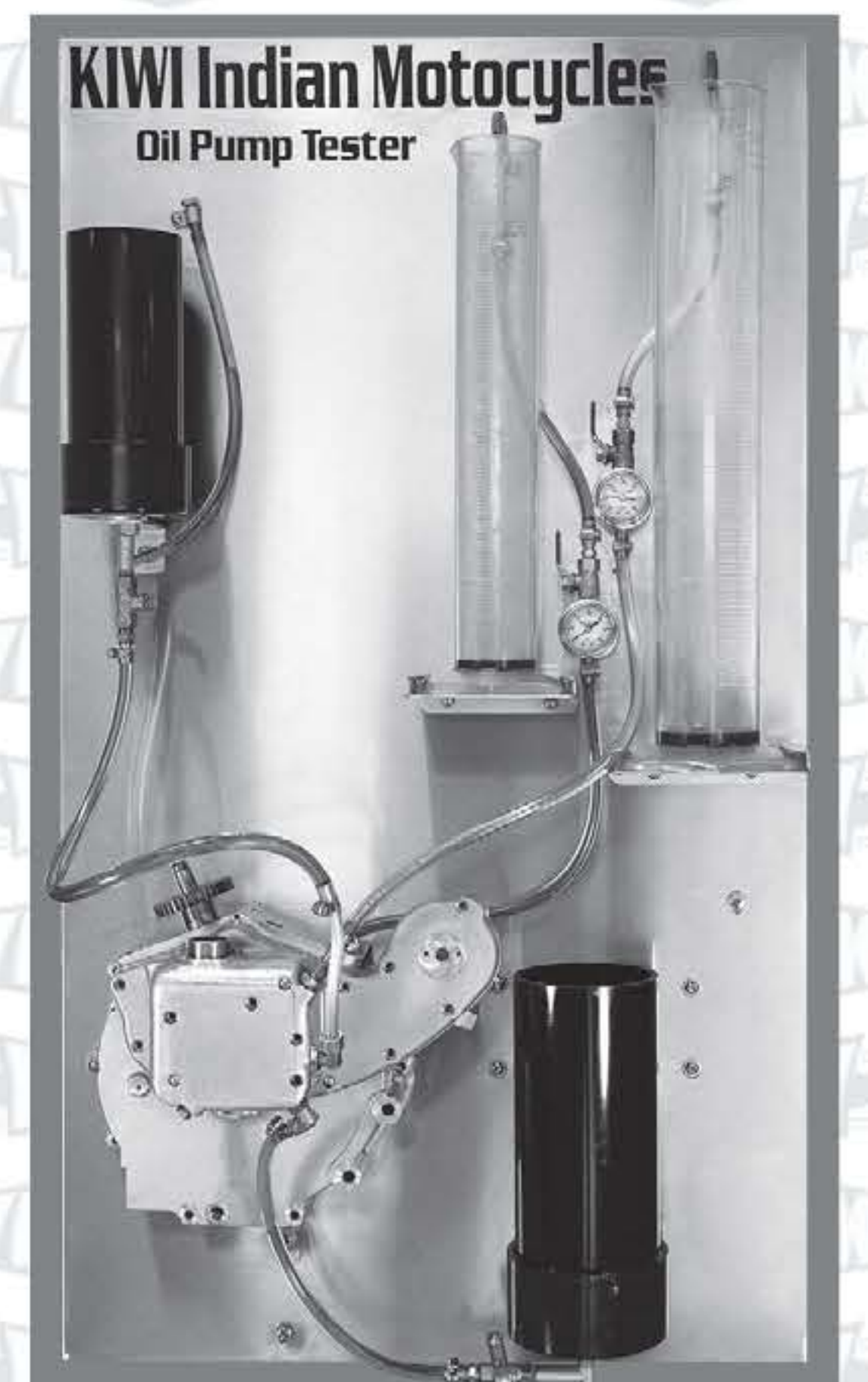
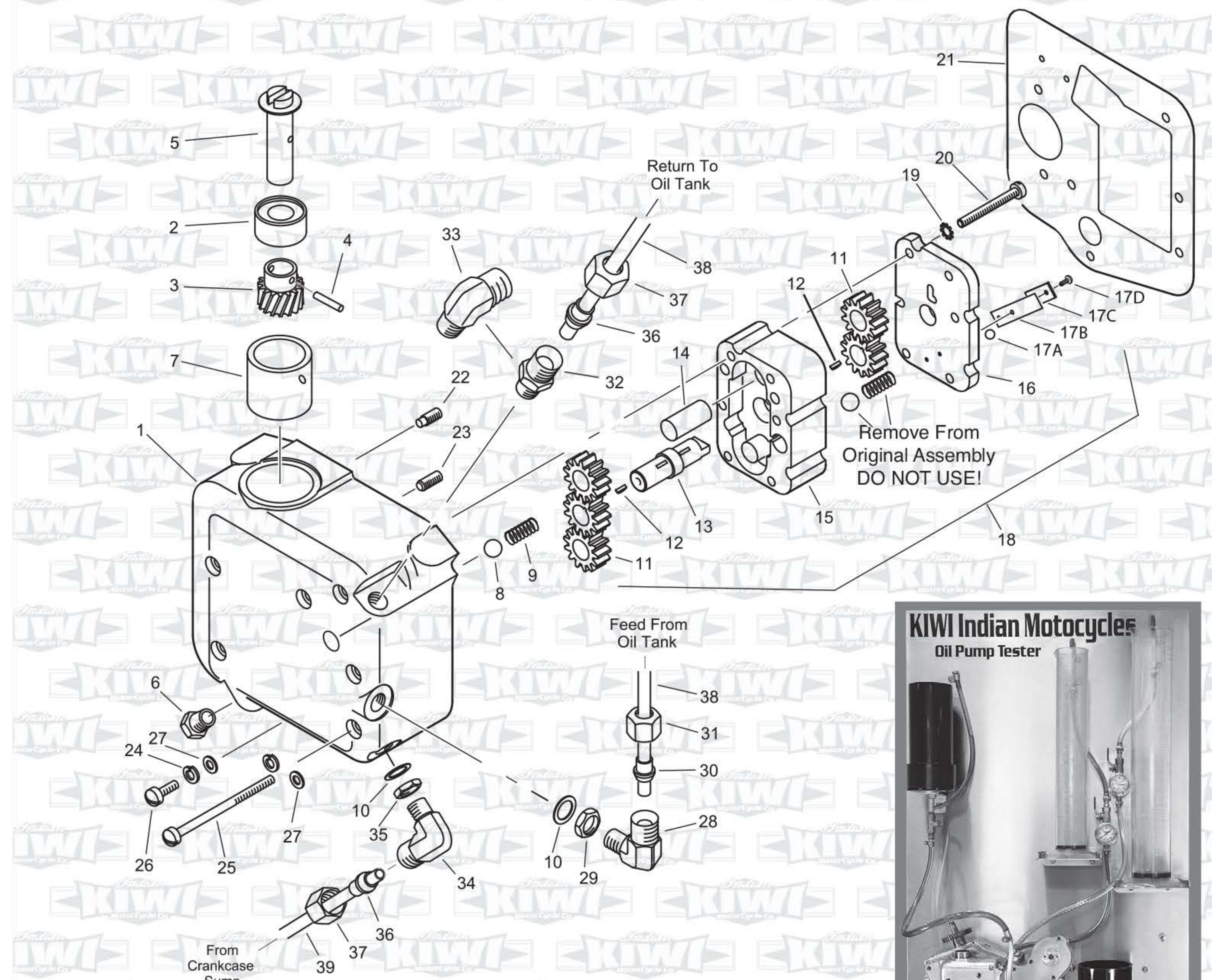

KIWI Oil Pump Dyno Tester for Indian motorcycle oil pumps.