

FLYWHEELS & CONNECTING RODS



Note: All KIWI flywheels, rods, shafts and related parts are *made in the USA* and are exclusive to KIWI. We do not resell others or sell imported parts. My name is associated with quality and durability which you depend on. I'm a hands on guy working on Indians every single day and my team sees the damage done by others inferior quality parts.

We step up to the plate as we are the only company in the world that manufactures complete new proprietary Indian engines and replica bikes further proof that we build the best parts, that's the *KIWI difference*. Within our website you will also see me riding my Indians all over the country and world (and never with any back up vehicle) proving my products are the best. *We know you want the best and that's what we stand for.*

No.	Part No.	Description	Year
1	86128	Flywheels: 74", pr.(incl. #8)	22-48
1	424026-80	Flywheels: 80", pr.(incl. #8)	32-53
1	424026-84	Flywheels: 84", pr.(incl. #8)	32-53
1	424026-88	Flywheels: 88", pr.(incl. #8)	32-53
1	424026-92	Flywheels: 92", pr.(incl. #8)	32-53
2	424026B-74 424026B-80 424026B-84	Balanced flywheel assembly: Includes flywheels with shafts and rods, precision honed and fully assembled. State 74, 80, 84	32-53
Note: Pistons will need to be ordered at the same time for correct balance.			
3	43067	Crank pin	22-53
4	41043	Drive shaft	26-48
5	773002	Drive shaft: 80", spline	50-53
Note: 80" shafts are splined and are to be fitted up to a torque evener dampener assembly. Only use this shaft if using the torque evener assembly. If you are building an engine without the torque evener assembly, use 41043 drive shaft			
6	26B21	Key: Pinion and drive shaft to flywheel (2)	26-53
7	39586	Pinion shaft	22-55
8	28B305	Dowel pin: Flywheel thrust washer (8)	22-53
9	27B174-047	.047 Thrust washer: Pinion & drive shaft	28-53
9	27B174-057	.057 Thrust washer: Pinion & drive shaft	28-53
9	27B174-062	.062 Thrust washer: Pinion & drive shaft	28-53
9	27B174-072	.072 Thrust washer: Pinion & drive shaft	28-53
9	27B174-082	.082 Thrust washer: Pinion & drive shaft	28-53
9	27B174-087	.087 Thrust washer: Pinion & drive shaft	28-53
10	D200	Lock washer: Pinion & drive shaft (2)	22-53
11	D180	Nut: Drive & pinion shaft (2)	22-53
12	751403-K	Screw kit: Lock washer, set of 4	22-53
13	50311	.047 Thrust washer: Crank pin	22-53
13	50311-A	.052 Thrust washer: Crank pin	22-53
13	27B268	.057 Thrust washer: Crank pin	22-53

No.	Part No.	Description	Year
13	44386	.062 Thrust washer: Crank pin	22-53
13	44386-A	.067 Thrust washer: Crank pin	22-53
13	50310	.072 Thrust washer: Crank pin	22-53
13	50310-A	.077 Thrust washer: Crank pin	22-53
13	50310-B	.082 Thrust washer: Crank pin	22-53
13	50310-C	.092 Thrust washer: Crank pin	22-53
14	22B23	Lock washer: Crank pin nut (2)	22-53
15	22B22	Nut: Crank pin (2)	22-53
16	27B182	Retainer: Roller, drive & pin shaft (6)	22-53
17	16A15-U	Roller: .249 (108)	22-53
17	16A15-T	Roller: .2495 (108)	22-53
17	16A15	Roller: .250 STD (108)	22-53
17	16A15-V	Roller: .2505 (108)	22-53
17	16A15-W	Roller: .251 (108)	22-53
18A	40426	Spacer: Drive shaft	34-51
18B	801025	Spacer: Drive shaft, when using #21, 22	52-53
Note: We recommend updating 34-51 models drive shaft spacer 18A with #18B, 20, 21 for positive oil control.			
19	924016	.063 Thrust washer: Engine sprocket	22-53
19	924017	.070 Thrust washer: Engine sprocket	22-53
19	924018	.077 Thrust washer: Engine sprocket	22-53
19	924019	.084 Thrust washer: Engine sprocket	22-53
19	924020	.091 Thrust washer: Engine sprocket	22-53
19	924020-A	.095 Thrust washer: Engine sprocket	22-53
19	924021	.098 Thrust washer: Engine sprocket	22-53
19	924021-A	.100 Thrust washer: Engine sprocket	22-53
19	924022	.105 Thrust washer: Engine sprocket	22-53
19	924024	.112 Thrust washer: Engine sprocket	22-53
19	924023	.119 Thrust washer: Engine sprocket	22-53
19	924007	.124 Thrust washer: Engine sprocket	22-53
19	924006	.132 Thrust washer: Engine sprocket	22-53
19	37624	.140 Thrust washer: Engine sprocket	22-53
19	22B190	.148 Thrust washer: Engine sprocket	22-53

Continued on page 6

FLYWHEELS & CONNECTING RODS

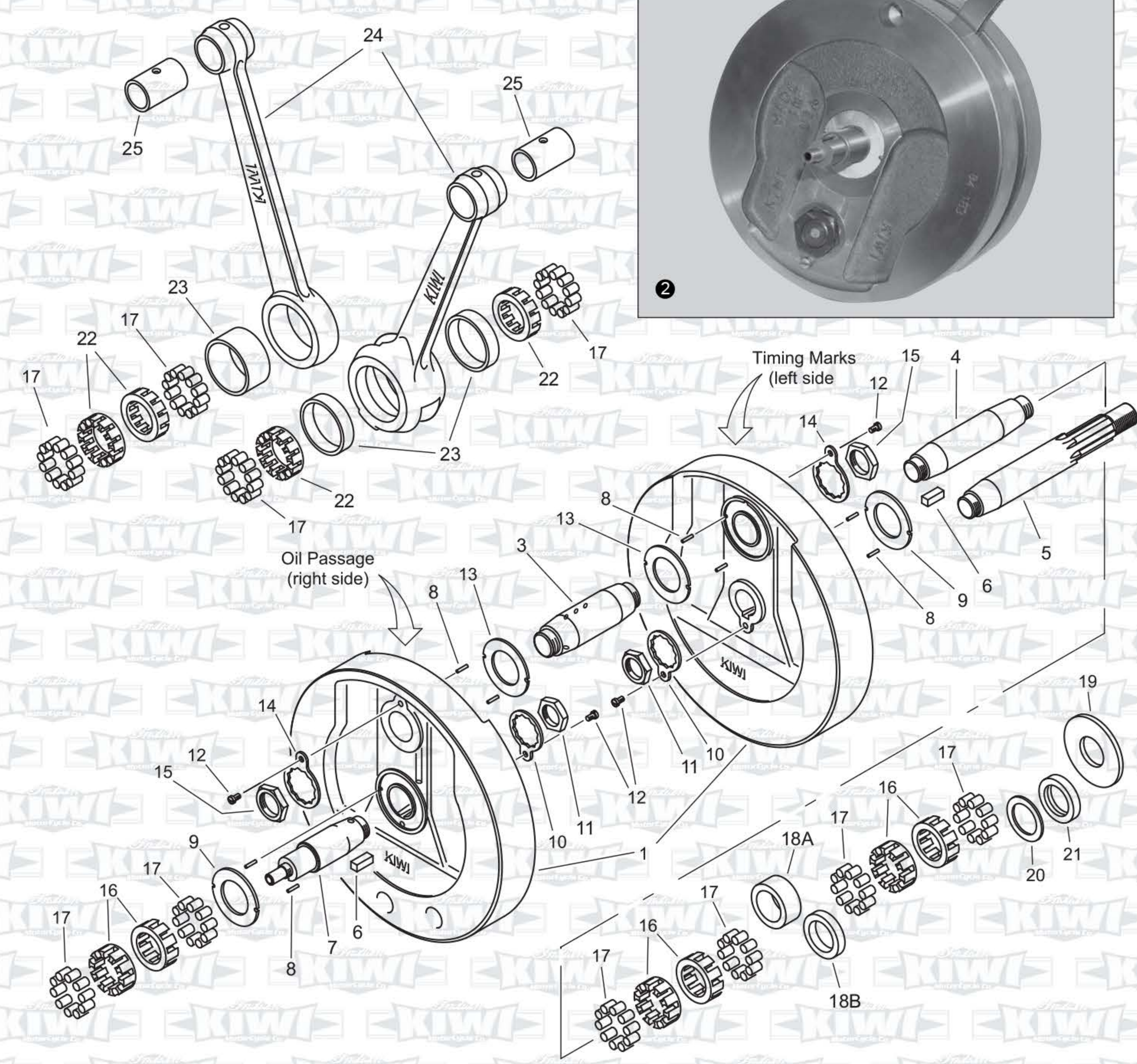

FLYWHEELS & CONNECTING RODS

No.	Part No.	Description	Year
19	22B189	.154 Thrust washer: Engine sprocket	22-53
19	22B188	.160 Thrust washer: Engine sprocket	22-53
19	22B188-A	.166 Thrust washer: Engine sprocket	22-53
19	41027	.170 Thrust washer: Engine sprocket	22-53
20	924014	Thrust washer: Drive housing	52-53
21	762016	Seal: Drive housing to shaft	52-53
Note: We recommend updating 34-51 models drive shaft spacer 18A with #18B, 20, 21 for positive oil control.			
22	27B181	Retainer: Roller, crank pin (4)	22-53
23	22B61/2	Rod race set: Set of 3	22-53
23	22B61/2-005	Rod race set: .005 o/s OD	22-53
23	22B61/2-010	Rod race set: .010 o/s OD	22-53
24	75305-I	Rods: Forged "I" beam rods w/o races and wrist pin bushings, pr. inci. 25	22-53
24	75305-H	Rods: Forged "H" beam rods w/o rod races, pr. incl. 25	22-53

Note: "I" beam vs. "H" beam. There are 2 different engineering philosophies and both are right. We go with the "I" beam rod as they are bullet proof.

Note: KIWI forged connecting rods are the best money can buy for Indians, period. Our rods are made from premium 4340 (hi performance racing engine material) for the ultimate in strength and durability making these absolutely indestructible. Original rods (and competitors) are marginal at best and the way I look at it, KIWI rods are your insurance policy. It's a small price to pay in order to save you the expense of a catastrophic (and expensive) failure down the road. This is an extremely good upgrade. Beware of import imitations as they are all junk.

24	75305-IF	Fitted "I" beam rods: Includes rod races and wrist pin bushings fitted and honed to size (order crank pin & rollers at the same time to ensure exact fit)	22-53
25	27B2	Bushing: Wrist pin (2)	22-53
25	27B2-010	Bushing: Wrist pin, .010 oversize outside diameter	22-53
25	27B2-R	Bushing: Wrist pin, suits "H" beam rods (2)	22-53
-	42189	Tool: Rod race installation & removal	22-5
-	L-10030	Magnaflux rods: pr.	all
-	L-10034	Rod rebuilding service: Rebuild your original rods	all

Rebuilding service: We offer rebuilding services for your flywheels and connecting rods in our service dept.

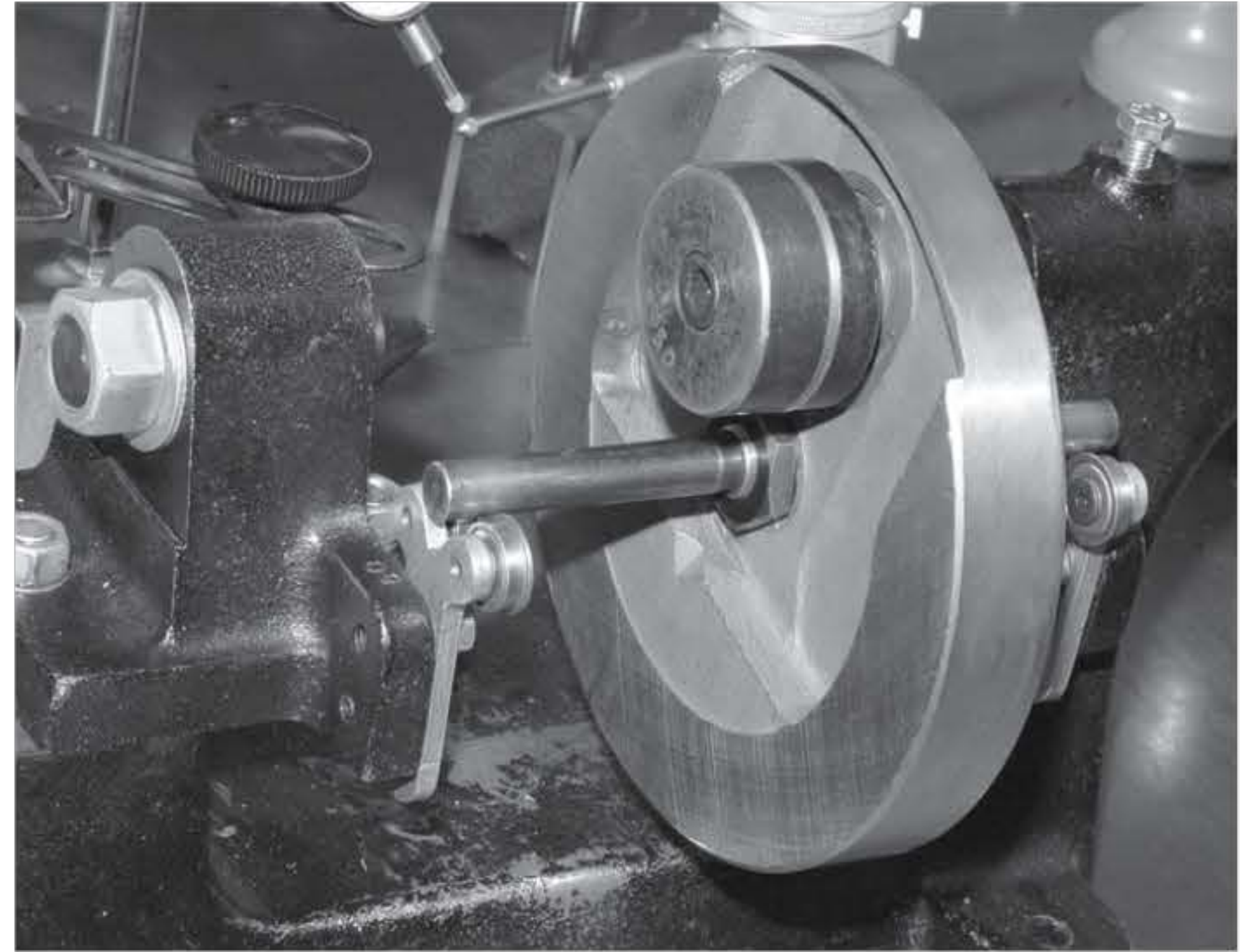

Balancing flywheels individually

