

CAMS, FOLLOWERS & PUSHRODS



No.	Part No.	Description	Year
1	86012	Cam cover: Original style	38-53
1	86012-L	Cam Cover: Loaded, Incl. 2, 3A, 3B & 4	38-53
2	22B14	Bushing: Lift pin in cam cover .562 O.D. (2)	22-53
2	22B14-003	Bushing: .003 o/s (2)	22-53
3	40474	Bushing: Camshaft, rear w/liner, stock 1.059 O.D.	36-53
3A	40474-R	Bushing: Improved with leak free oil seal	36-53
Note: This bushing is a big improvement over the original as it solves a typical oil leak area.			
3B	40474-S	Seal: Fits 40474R bushing	36-53
4	38106	Bushing: Camshaft, front, cam cover .876 O.D.	33-53
5	16A68	Dowel pin: Cam cover (2)	22-53
6	74051	Gasket: Cam cover	32-53
6	74051-R	Gasket: Cometic	32-53
7A	39730	Front push rod STD .404 dia. (2)	22-53
7A	39730-002	Front push rod .002 o/s .406 dia (2)	22-53
7A	39730-004	Front push rod .004 o/s .408 dia (2)	22-53
7B	39732	Rear push rod STD .404 dia. (2)	22-53
7B	39732-002	Rear push rod .002 o/s .406 dia (2)	22-53
7B	39732-004	Rear push rod .004 o/s .408 dia (2)	22-53
8	16A55	Bolt: Tappet adjusting (4)	22-53
9	612001	Locknut: Tappet adjusting bolt (4)	22-53
9B	35W242	Wrench: Tappet adjusting, (2)	22-53
10	37904	Key: Gear to pinion shaft	22-53
11	37350	Nut: Gear to shaft, L/H	33-53
12	37550	Washer: Gear nut	33-53
13	38415	Gear: Cam drive, pinion shaft	22-53
Note: This gear must be a press fit onto the pinion shaft. There are some on the market that are a slip fit which will fail during service.			
13A	33T69	Tool: Pinion gear removal	22-53
13B	33T69-A	Tool: Pinion gear installation (No hammering required)	22-53
14	22B16	Roller: Cam follower (4)	22-53
15	25B264	Rivet: Cam follower (4)	22-53
16	40455	Bushing: Camshaft, crankcase .814 O.D. (2)	36-53
16	40455-005	Bushing: .005 o/s (2)	36-53
17A	22B12	Lift pin: (2)	22-38
17B	22B13	Bushing: Lift pin (2)	22-38
17B	22B13-005	Bushing: Lift pin, .005 o/s (2)	22-38
17C	41852*	Lift pin w/bushing: .692 O.D. (2)	39-53
17C	41852-005	Lift pin w/bushing: .005 o/s .692 O.D. (2)	39-53

No.	Part No.	Description	Year
18	KI-10012	Thrust washer kit: Camshafts	22-53
19	38208	Cam follower set: Std, set of 4	22-53
19	41848	Cam follower set: Bonneville, set of 4	22-53
Note: KIWI cam followers are made from billet 8620 alloy steel and heat treated to RC60 for superior strength and wear resistance. KIWI cam followers are the best cam followers ever made for Indian motorcycles. By fitting the best, no wear will take place therefore tappet adjustments are almost non-existent.			
20	92885	Cams: Std grind, pr.	22-53
20	92908-B	Cams: Bonneville grind, pr.	22-53
20	92908-D	Cams: Daytona grind, pr.	22-53
20	92908D-V	Cams: Death Valley grind (for torque & high speed riding, pr.	22-53
Note: KIWI cams are made from solid billet and are manufactured as one (1) piece like the originals for strength and timing accuracy. Our material is 8620 and heat treated to Rc 60 which makes these cams last forever. Your tappets will require far less adjusting with our cam train components as they don't wear.			
Note: For the latest in cams, upgrades and cam train specs., please visit our website www.KiwiIndian.com			
20	92908-G	Cam gears only: Pr.	
Note: These new gears will accept different lobe configurations that others sell. Their lobes are then riveted onto these lobes.			
21	769003	Shaft: Front cam, slotted	48-53
22	40509	Shaft: Front cam, worm drive	36-47
23	538008	Key: Gear to shaft	36-53
24	40436	Shaft: Rear cam	36-53
25	751511-K	Screw kit: Cam cover, stainless	22-53
26			
27A	37551	Felt	33-53
27B	37552	Retainer: Felt	33-53
27C	37551-R	Oil seal: Pinion shaft in cam cover	33-53
Note: 37551-R is an upgrade over the stock 37551 felt and 37552 retainer as it provides a 100% seal. This seal eliminates oil loss through the felt.			
28	538008	Key: Helical gear to shaft	36-53
29	605014-K	Nut kit: Helical gear	36-53
30	101029	Helical gear: Oil pump drive	36-53
31	540053	Gasket set: Complete, less seals & felts	38-53
31	540053-R47 540053-R53	Gasket set, less seals & felts: Cometic	38-47 48-53
*Note: KIWI 41852 Lift pins and bushings have been improved into a one (1) piece design for superior strength and durability. The original design had a tendency to come loose and break.			

CAMS, FOLLOWERS & PUSHRODS

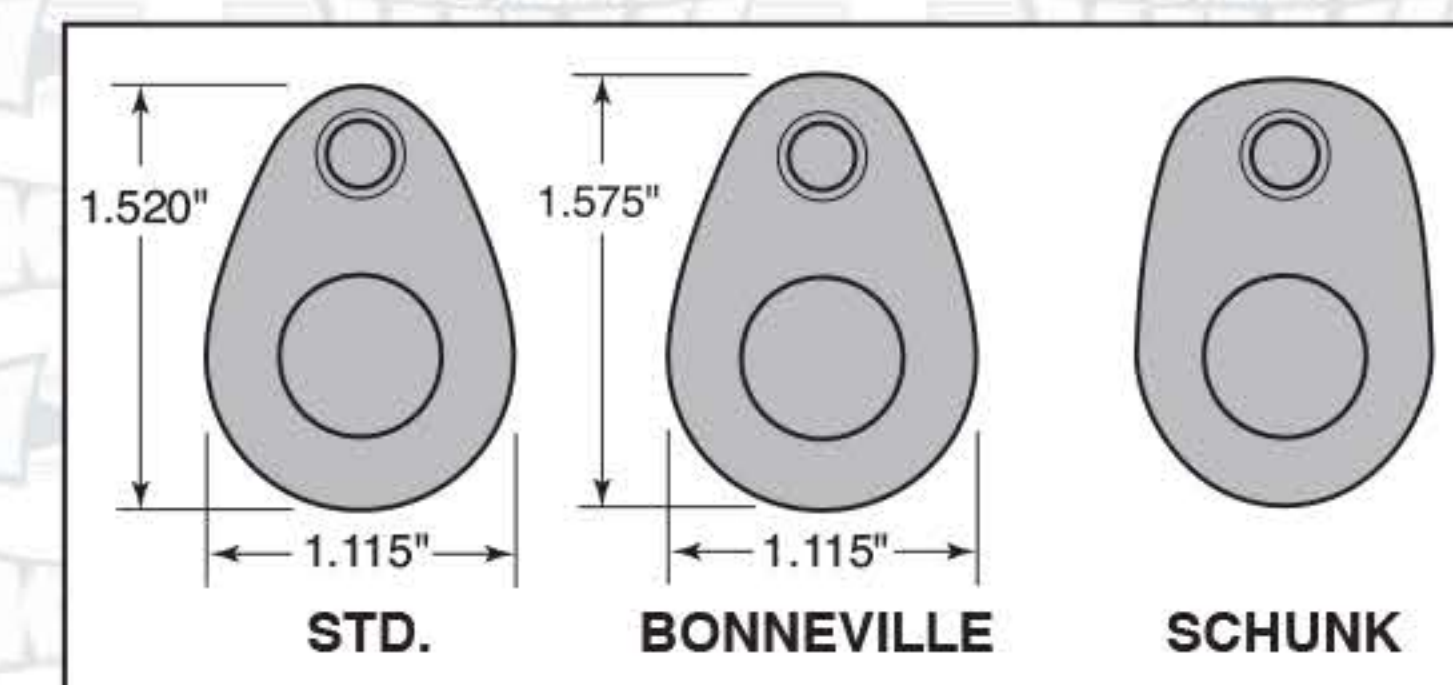
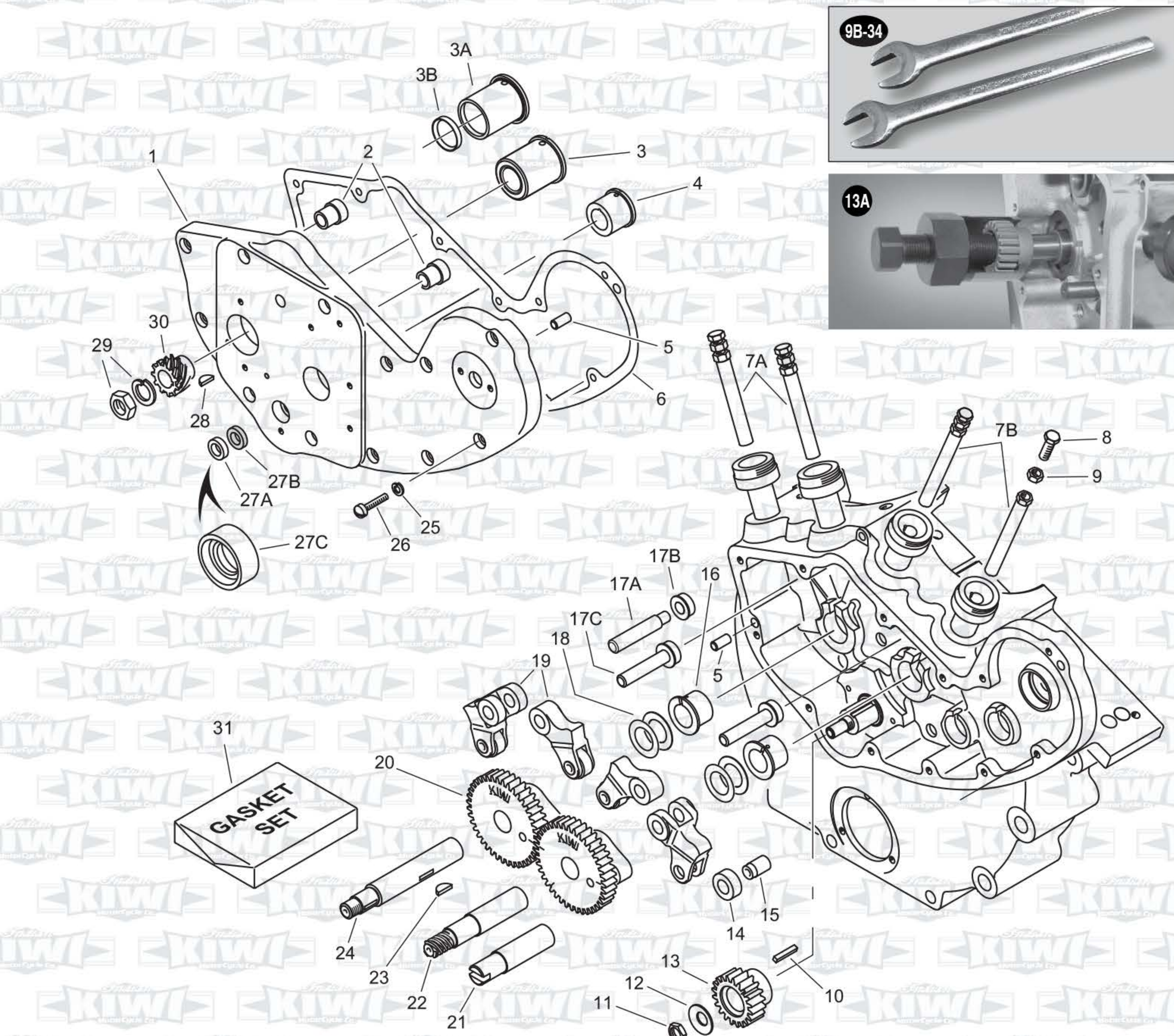

Rebuilding service: We also offer rebuilding services for your cam train in our service dept.

